

LOCATION MAP
NOT TO SCALE

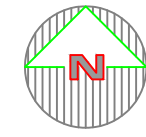

SITE DATA:

OWNER / DEVELOPER:
STREET ADDRESS:
PROJECT LOCATION:
TOWN TAX MAP DATA:
SITE AREA :

TOWN OF YORKTOWN
363 UNDERHILL AVE
YORKTOWN HEIGHTS, NY 10598
TOWN OF YORKTOWN
795 ROUTE 6
SHRUB OAK, NY 10588
SECTION 16.07, BLOCK 1, LOT 38
12.50 ACRES (544,500 SF)

NOTE: WORK START DATE WILL BE BASED ON
ISSUANCE OF NYS DEC WETLAND PERMIT.

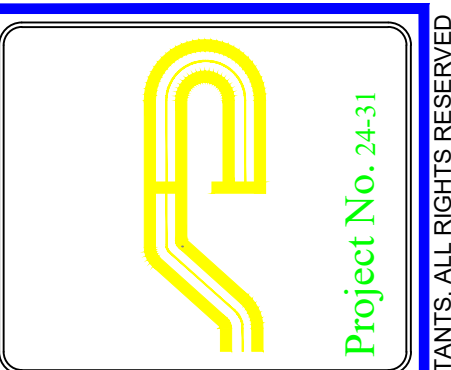

Project No. 24-31

Site Design Consultants

Civil Engineers • Land Planners
251-J Underhill Avenue, Yorktown Heights, NY 10598
(914) 962-4488 - Fax: (914) 962-7386
www.sitedesignconsultants.com

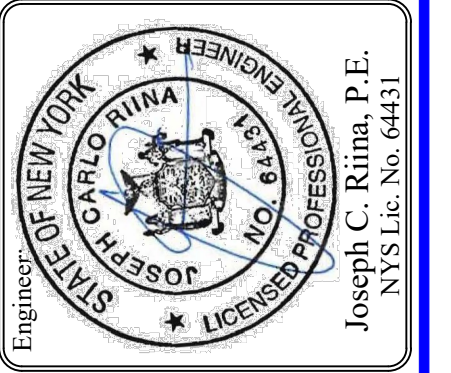

Revisions:	No.	Date	Comments
	1	4/29/26	All Sewer Plan

SCALE:	#####
DRAWN BY:	JPT
DATE:	3-12-25

SEWER CONNECTION PLAN

PREPARED FOR
TOWN OF YORKTOWN
GOLF COURSE
795 EAST MAIN STREET (ROUTE 6)
Yorktown, NY

Sheet 1 of 7

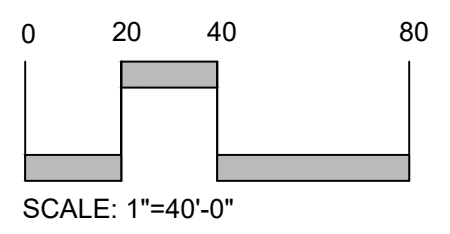
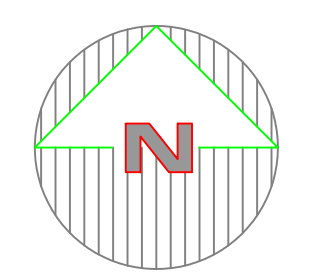
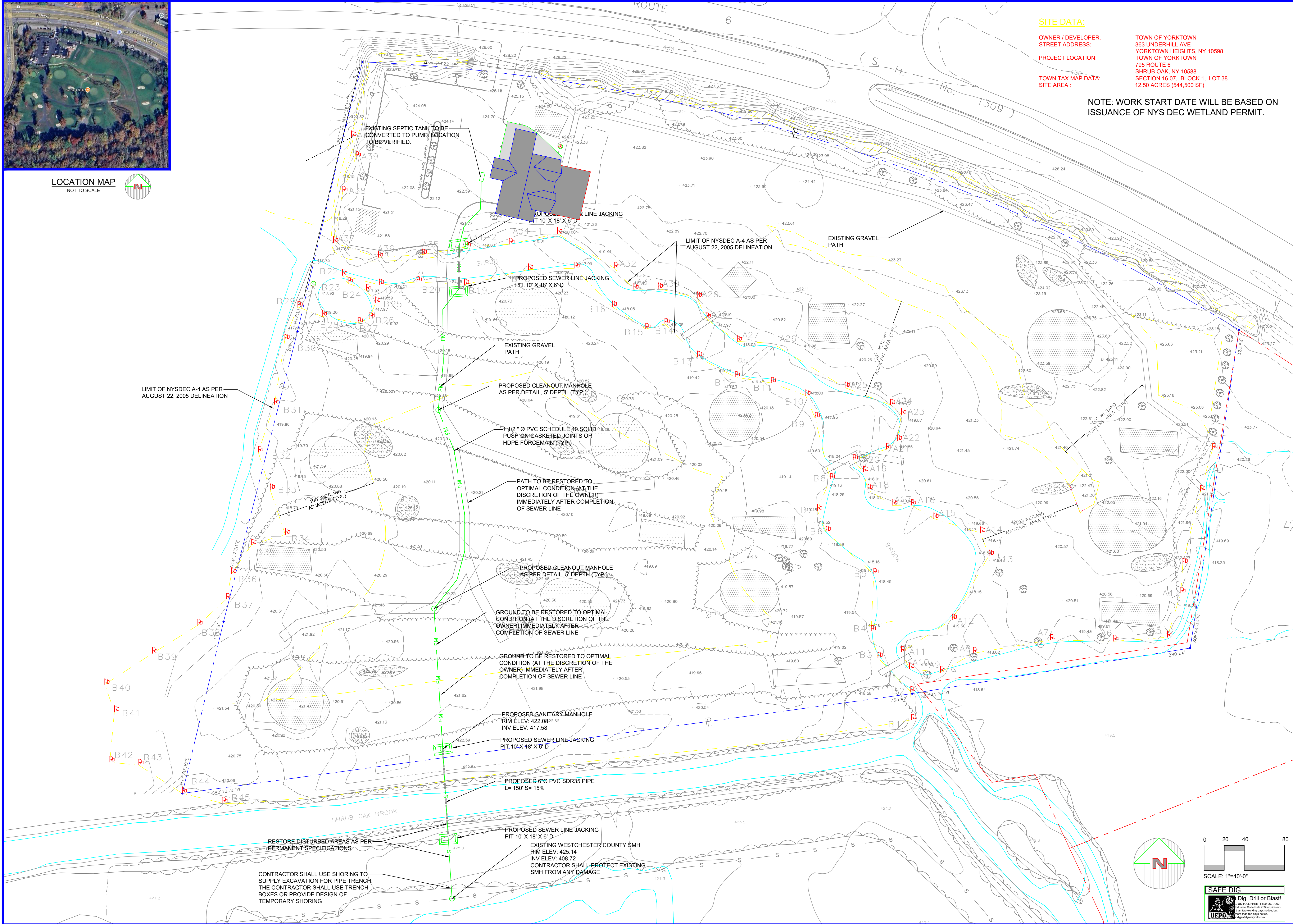

SCALE: 1"=40'-0"

SAFE DIG
Dig, Drill or Blast!
USE TOOLS FREE 1-800-962-7962
Additional Code Book 703 requires no
more than working days notice, but
from their own data records.
regulatory.ny.gov

NOTE: UNAUTHORIZED ALTERATIONS OR ADDITIONS TO THIS DRAWING IS A VIOLATION OF SECTION 7209 (2)(F) OF THE NEW YORK STATE EDUCATION LAW.

COPYRIGHT © 2020 BY SITE DESIGN CONSULTANTS. ALL RIGHTS RESERVED.

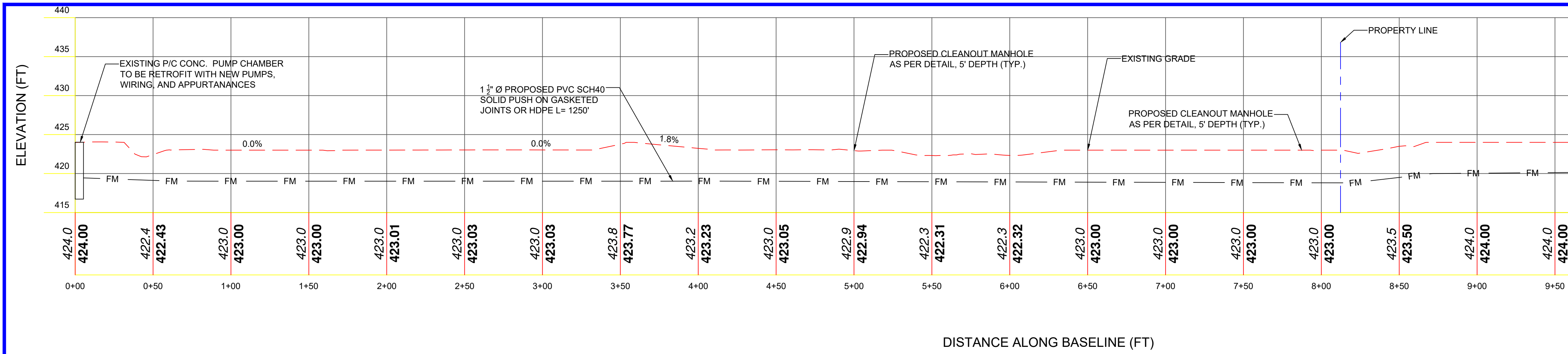

DISTANCE ALONG BASELINE (FT)
 ALT - FORCEMAIN
 VERT. SCALE: 1" = 8
 HORIZ. SCALE: 1" = 40

BREAK IN PROFILE

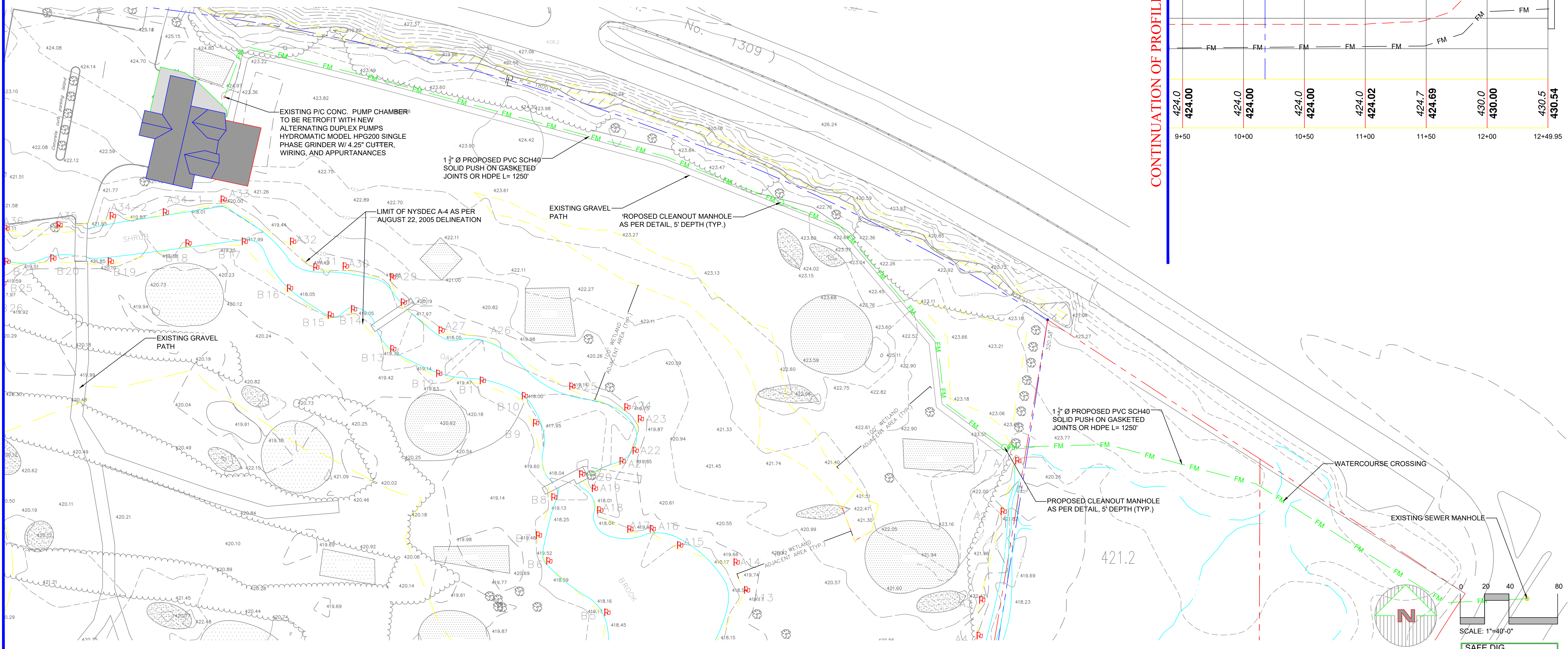

CONTINUATION OF PROFILE

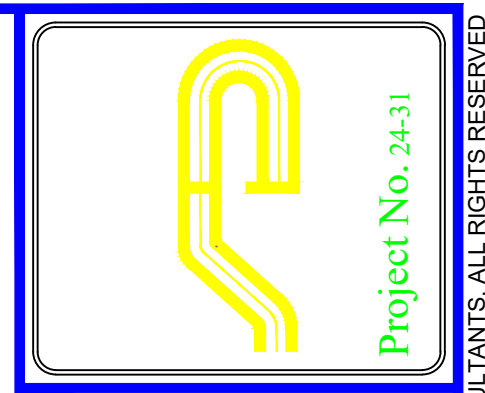
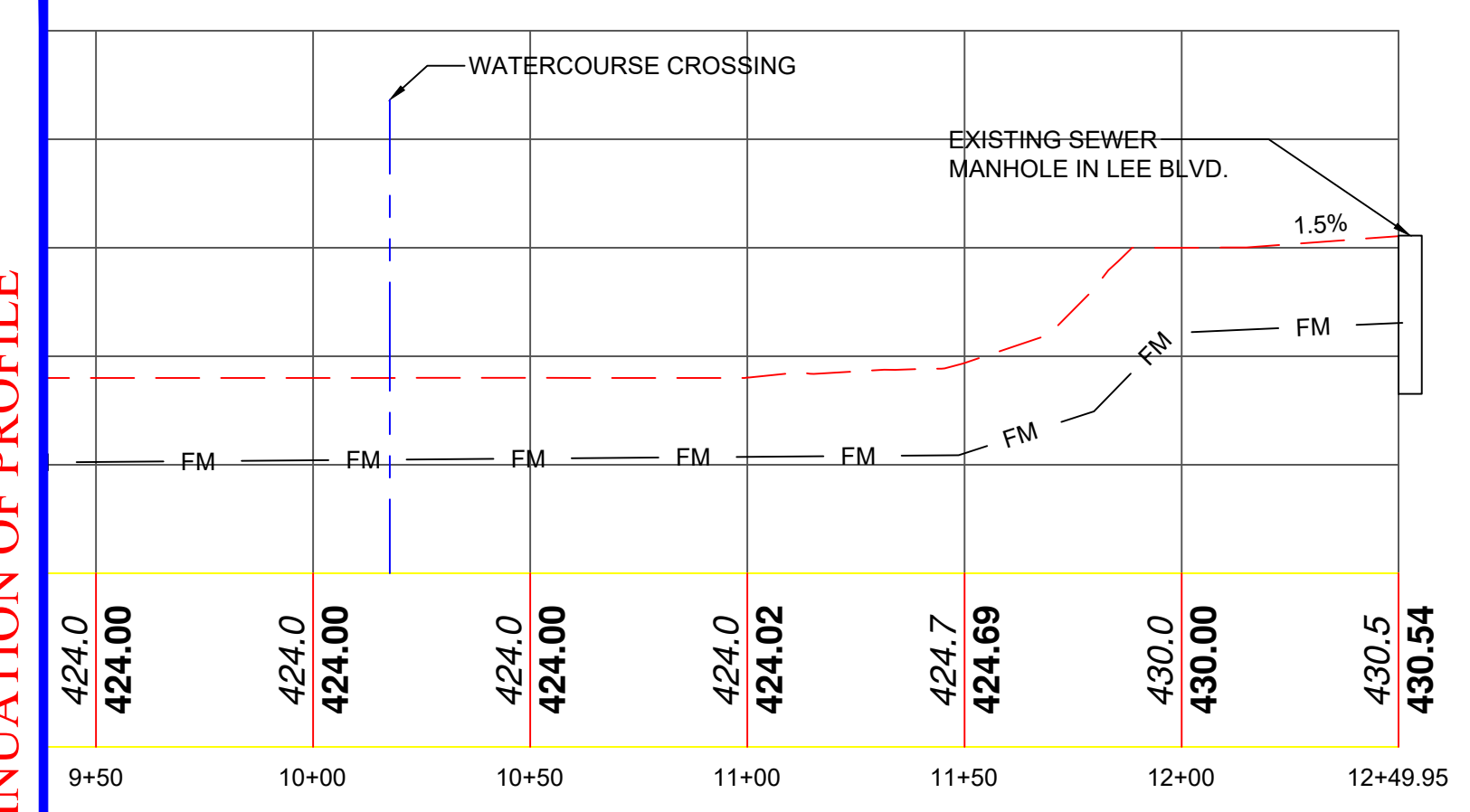

Site Design Consultants
 Civil Engineers • Land Planners
 251-F Underhill Avenue, Yorktown Heights, NY 10598
 (914) 962-4488 - Fax: (914) 962-7386
 www.sitedesignconsultants.com



No.	Date	Comments
1	4/29/26	All Sewer Plan

SCALE: #####
 DRAWN BY: JPT
 DATE: 3-12-25

ALTERNATE SEWER PLAN

PREPARED FOR
TOWN OF YORKTOWN
GOLF COURSE
 795 EAST MAIN STREET (ROUTE 6)
 Yorktown, NY

NOTE: UNAUTHORIZED ALTERATIONS OR ADDITIONS TO THIS DRAWING IS A VIOLATION OF SECTION 7209 (2)(F) OF THE NEW YORK STATE EDUCATION LAW.

SAFE DIG
 Dig, Drill or Blast!
 USE POI
 Dig, Drill or Blast!
 USE POI

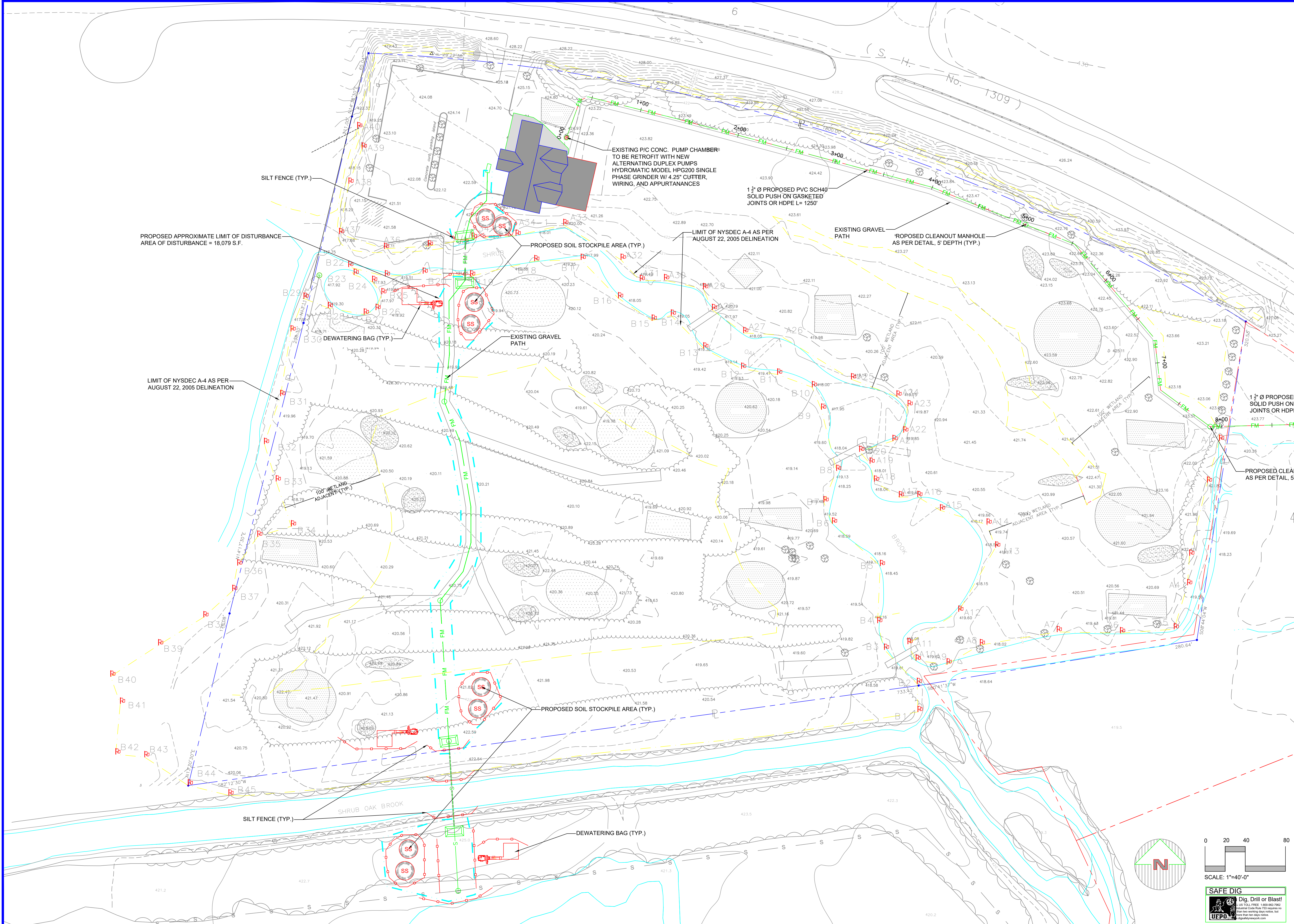

PROPOSED APPROXIMATE LIMIT OF DISTURBANCE
AREA OF DISTURBANCE = 18,079 S.F.

LIMIT OF NYSDEC A-4 AS PER
AUGUST 22, 2005 DELINEATION

EXISTING P/C CONC. PUMP CHAMBER
TO BE RETROFIT WITH NEW
ALTERNATING DUPLEX PUMPS
HYDROMATIC MODEL HPG200 SINGLE
PHASE GRINDER W/ 4.25" CUTTER,
WIRING, AND APPURTANANCES

1.5" Ø PROPOSED PVC SCH40
SOLID PUSH ON GASKETED
JOINTS OR HDPE L= 1250'

PROPOSED CLEANOUT MANHOLE
AS PER DETAIL, 5' DEPTH (TYP.)

PROPOSED SOIL STOCKPILE AREA (TYP.)

EXISTING GRAVEL
PATH

1.5" Ø PROPOSED
SOLID PUSH ON GASKETED
JOINTS OR HDPE

PROPOSED CLEAN
AS PER DETAIL, 5'

SILT FENCE (TYP.)

DEWATERING BAG (TYP.)

PROPOSED SOIL STOCKPILE AREA (TYP.)

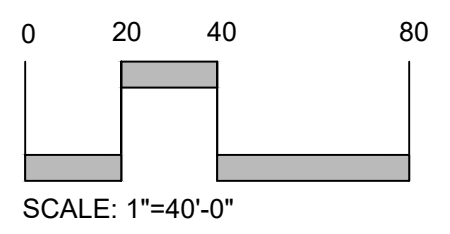
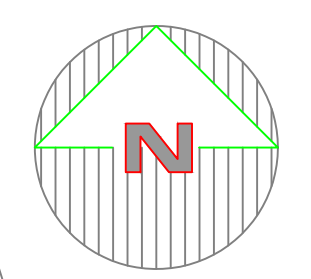

SAFE DIG
Dig, Drill or Blast!
USE THIS FREE 1-800-962-7962
National Code Book. It requires no
more than 10 minutes to read, but
it can save your life.
www.safe-dig.com

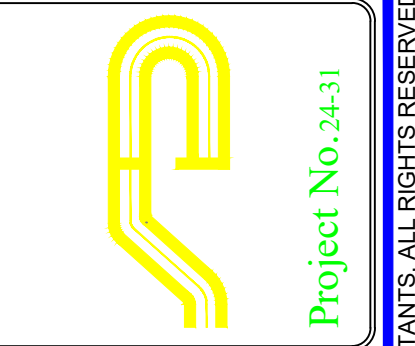

Site Design Consultants
Civil Engineers • Land Planners
251-F Underhill Avenue, Yorktown Heights, NY 10598
(914) 962-4488 - Fax: (914) 962-7386
www.sitedesignconsultants.com

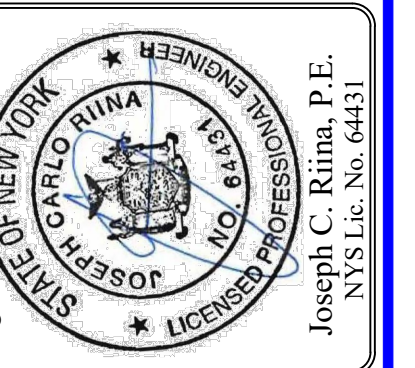

Revisions:	No.	Date	Comments
	1	4/29/26	All Sewer Plan

SCALE: #####
DRAWN BY: JPT
DATE: 3-12-25

EROSION & SEDIMENT CONTROL PLAN

PREPARED FOR
TOWN OF YORKTOWN
GOLF COURSE
795 EAST MAIN STREET (ROUTE 6)
Yorktown, NY

Sheet 4 of 7

NOTE: UNAUTHORIZED ALTERATIONS OR ADDITIONS TO THIS DRAWING IS A VIOLATION OF SECTION 7209 (2)(F) OF THE NEW YORK STATE EDUCATION LAW.

GENERAL EROSION CONTROL NOTES:

- Contractor shall be responsible for compliance with all sediment and erosion control practices. The sediment and erosion control practices are to be installed prior to any major soil disturbances, and maintained until permanent protection is established. Road surface flows from the site should be dissipated with tracking pad or appropriate measures during adjacent road shoulder regrading. Contractor is responsible for the installation and maintenance of all soil erosion and sedimentation control devices throughout the course of construction.
- Catch basin inlet protection must be installed and operating at all times until tributary areas have been stabilized. When possible flows should be stabilized before reaching inlet protection structure. Timely maintenance of sediment control structures is the responsibility of the Contractor.
- All structures shall be maintained in good working order at all times. The sediment level in all sediment traps shall be closely monitored and sediment removed promptly when maximum levels are reached or as ordered by the engineer. All sediment control structures shall be inspected on a regular basis, and after each heavy rain to insure proper operation as designed. An inspection schedule shall be set forth prior to the start of construction.
- The locations and the installation times of the sediment capturing standards shall be as specified in these plans, as ordered by the Engineer, and in accordance with the latest edition of the "New York Standards and Specifications for Erosion and Sediment Control" (NYSSESC).
- All topsoil shall be placed in a stabilized stockpile for reuse on the site. All stockpile material required for final grading and stored on site shall be temporarily seeded and mulched within 7 days. Refer to soil stockpile details.
- Any disturbed areas that will be left exposed more than 7 days and not subject to construction traffic, shall immediately receive temporary seeding. Mulch shall be used if the season prevents the establishment of a temporary cover. Disturbed areas shall not be limed and fertilized prior to temporary seeding.
- All disturbed areas within 500 feet of an inhabited dwelling shall be wetted as necessary to provide dust control.
- The contractor shall keep the roadways within the project clear of soil and debris and is responsible for any street cleaning necessary during the course of the project.
- Sediment and erosion control structures shall be removed and the area stabilized when the drainage area has been properly stabilized by permanent measures.
- All sediment and erosion control measures shall be installed in accordance with current edition of NYSSESC.
- All regraded areas must be stabilized appropriately prior to any rock blasting, cutting, and/or filling of soils. Special care should be taken during construction to insure stability during maintenance and integrity of control structures.
- Any slopes graded at 3:1 or greater shall be stabilized with erosion blankets to be staked into place in accordance with the manufacturer's requirements. Erosion blankets may also be required at the discretion of Town officials or Project Engineer. When stabilized blanket is utilized for channel stabilization, place all of the volume of seed mix prior to laying net, or as recommended by the manufacturer.
- To prevent heavy construction equipment and trucks from tracking soil off-site, construct a pervious crushed stone pad. Locate and construct pads as detailed in these plans.
- Contractor is responsible for controlling dust by sprinkling exposed soil areas periodically with water as required. Contractor to supply all equipment and water.
- Contractor shall be responsible for construction inspections as per NYSDEC GP-0-25-001 and Town of Yorktown.

MAINTENANCE OF TEMPORARY EROSION AND SEDIMENT CONTROL STRUCTURES:

- N.Y.S.D.E.C. GP-0-25-001 EXPOSURE RESTRICTIONS - States that any exposed earthwork shall be stabilized in accordance with the guidelines of this plan.
- Trees and vegetation shall be protected at all times as shown on the detail drawing and as directed by the Engineer.
 - Care should be taken so as not to channel concentrated runoff through the areas of construction activity on the site.
 - Fill and site disturbances should not be created which causes water to pond off site or on adjacent properties.
 - Runoff from land disturbances shall not be discharged or have the potential to discharge off site without first being intercepted by a control structure, such as a sediment trap or silt fence. Sediment shall be removed before exceeding 50% of the retention structure's capacity.
 - For finished grading, adequate grade shall be provided so that water will not pond on lawns for more than 24 hours after rainfall, except in swale flow areas which may drain for as long as 48 hours after rainfall.
 - All swales and other areas of concentrated flow shall be properly stabilized with temporary control measures to prevent erosion and sediment travel. Surface flows over cut and fill areas shall be stabilized at all times.
 - All sites shall be stabilized with erosion control materials within 7 days of final grading.
 - Temporary sediment trapping devices shall be removed from the site within 30 days of final stabilization.

MAINTENANCE SCHEDULE:

	DAILY	WEEKLY	MONTHLY	AFTER RAINFALL	NECESSARY TO MAINTAIN FUNCTION	AFTER APPROVAL OF INSPECTOR
SILT FENCE	---	---	INSP.	INSP.	CLEAN/REPLACE	REMOVE

MAINTENANCE OF PERMANENT CONTROL STRUCTURES DURING CONSTRUCTION:

The stormwater management system and outlet structure shall be inspected on a regular basis and after every rainfall event. Sediment build up shall be removed from the inlet protection regularly to insure detention capacity and proper drainage. Outlet structure shall be free of obstructions. All piping and drain inlets shall be free of obstruction. Any sediment build up shall be removed.

MAINTENANCE OF CONTROLS AFTER CONSTRUCTION:

Controls (including respective outlet structures) should be inspected periodically for the first few months after construction and on an annual basis thereafter. They should also be inspected after major storm events.

DEBRIS AND LITTER REMOVAL:

Twice a year, inspect outlet structure and drain inlets for accumulated debris. Also, remove any accumulations during each mowing operation.

STRUCTURAL REPAIR/REPLACEMENT:

Outlet structure must be inspected twice a year for evidence of structural damage and repaired immediately.

EROSION CONTROL:

Unstable areas tributary to the basin shall immediately be stabilized with vegetation or other appropriate erosion control measures.

SEDIMENT REMOVAL:

Sediment should be removed after it has reached a maximum depth of five inches above the stormwater management system floor.

TOPSOIL:

Existing topsoil will be removed and stored in piles sufficiently as to avoid mixing with other excavation. Stockpiles shall be surrounded by erosion control as outlined on these plans. The furnishing of new topsoil shall be of a better or equal to the following criteria (SS713.01 NYSDOT):

- The pH of the material shall be 5.5 to 7.6.
- The organic content shall not be less than 2% or more than 70%.
- Gradation: **SIEVE SIZE** **% PASSING BY WGT.**

2 INCH	100
1 INCH	85 TO 100
1/4 INCH	65 TO 100
NO. 200 MESH	20 TO 80

PERMANENT VEGETATIVE COVER:

- Site preparation:
 - 1.1. Install erosion control measures.
 - 1.2. Scarify compacted soil areas.
 - 1.3. Lime as required to pH 6.5.
 - 1.4. Fertilize with 10-6-4 4 lbs/1,000 S.F.
 - 1.5. Incorporate amendments into soil with disc harrow.
- Seed mixtures for use on swales and cut and fill areas.

MIXTURE		LBS./ACRE
ALT. A	KENTUCKY BLUE GRASS	20
	CREeping RED FESCUE	28
	RYE GRASS OR REDTOP	5
ALT. B	CREeping RED FESCUE	20
	REDTOP	2
	TALL FESCUE/SMOOTH BLOOMGRASS	20

SEEDING

- 3.1. Prepare seed bed by raking to remove stones, twigs, roots and other foreign material.
- 3.2. Apply soil amendments and integrate into soil.
- 3.3. Apply seed uniformly by cyclone seeder culti-packer or hydro-seeder at rate indicated.
- 3.4. Stabilize seeded areas in drainage swales.
- 3.5. Irrigate to fully saturate soil layer, but not to dislodge planting soil.
- 3.6. Seed between April 1st and May 15th or August 15th and October 15th.
- 3.7. Seeding may occur May 15th and August 15th if adequate irrigation is provided.

TEMPORARY VEGETATIVE COVER:

SITE PREPARATION:

1. Install erosion control measures.
2. Scarify areas of compacted soil.
3. Fertilize with 10-10-10 at 400/acre.
4. Lime as required to pH 6.5.

SEED SPECIES:

MIXTURE	LBS./ACRE
Rapidly germinating annual ryegrass (or approved equal)	20
Perennial ryegrass	20
Cereal oats	36

SEEDING:

Same as permanent vegetative cover

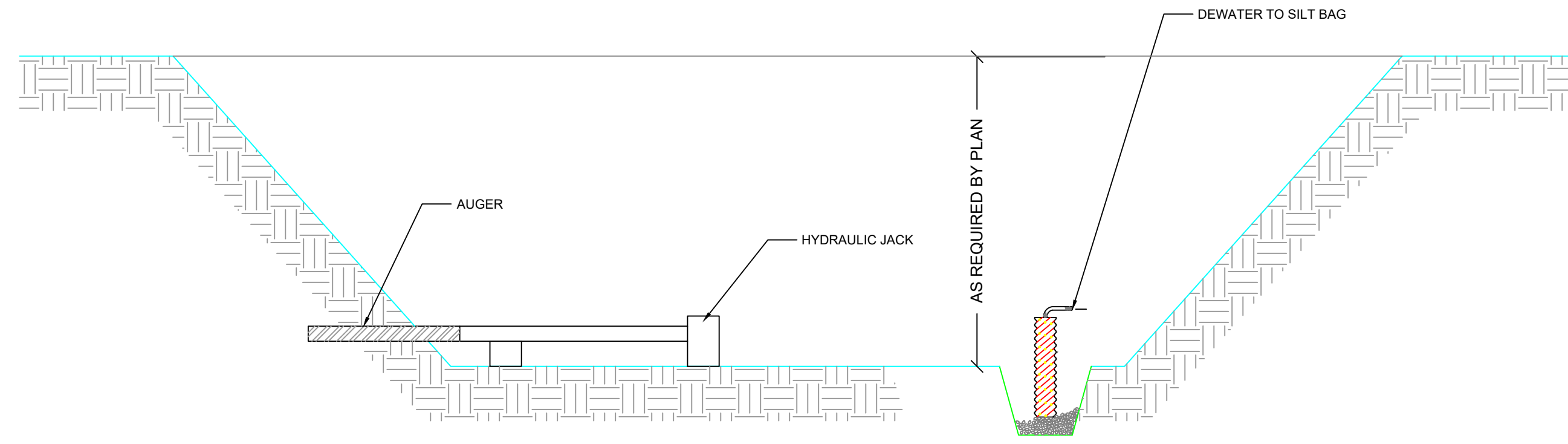

JP-1

JACKING PIT DETAIL

NOT TO SCALE

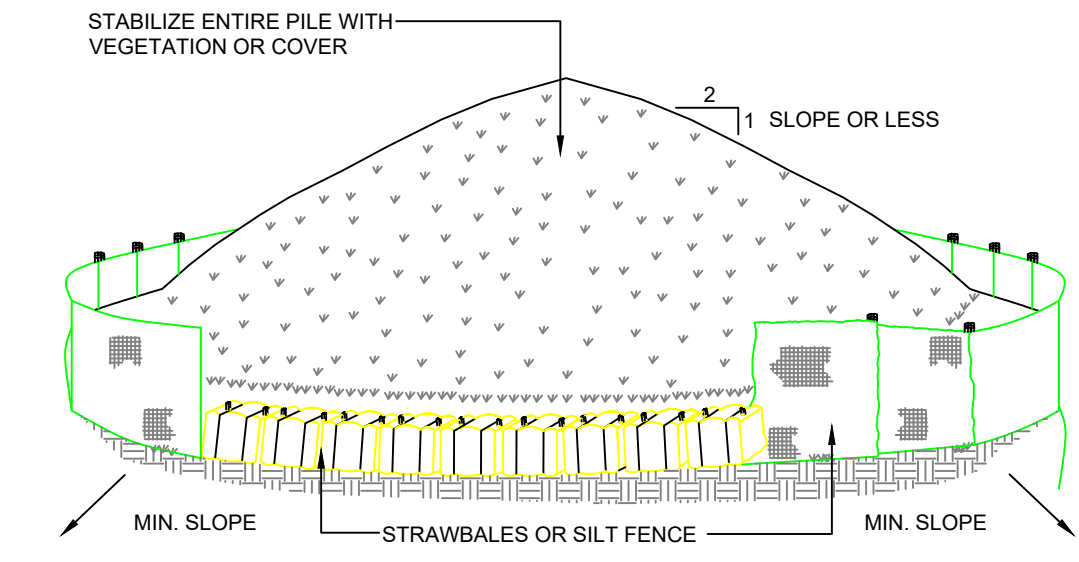

SYMBOL



NOTES:

- Area chosen for stockpiling operations shall be dry and stable.
- Maximum slope of stockpile shall be 1:2.
- Upon completion of soil stockpiling, each pile shall be surrounded with either silt fencing or strawbales, then stabilized with vegetation or covered.
- See detail for installation of silt fence.

E-1

SOIL STOCKPILE DETAIL

NOT TO SCALE

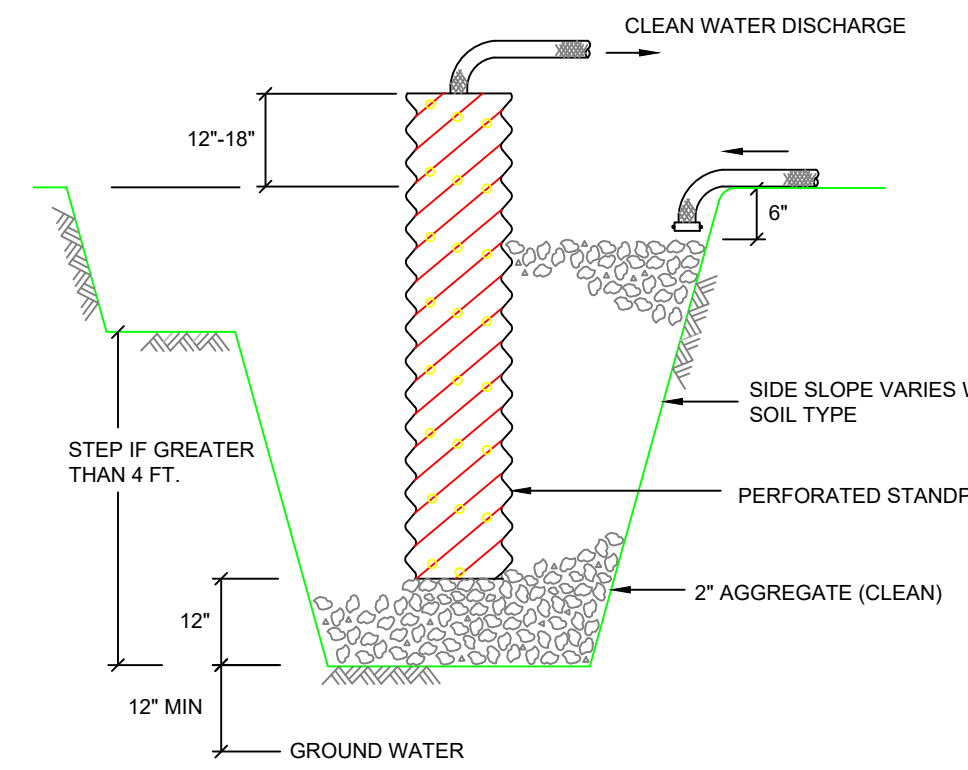

INSTALLATION NOTES:

- Pit dimensions are variable.
- The standpipe should be a perforated 12" to 24" diameter corrugated metal, PVC or HDPE pipe.
- A base of 2" clean aggregate should be placed in the pit to a depth of 12". After installing the standpipe, the pit surrounding the standpipe should then be backfilled with 2" aggregate.
- The standpipe should extend 12" - 18" above the lip of the pit.
- If discharge will be pumped directly to a storm drainage system, the standpipe should be wrapped with filter fabric before installation. If desired, 1/4" - 1/2" hardware cloth may be placed around the standpipe, prior to attaching the filter fabric, this will increase the rate of water seepage into the pipe.

E-2

DEWATERING PIT DETAIL

NOT TO SCALE

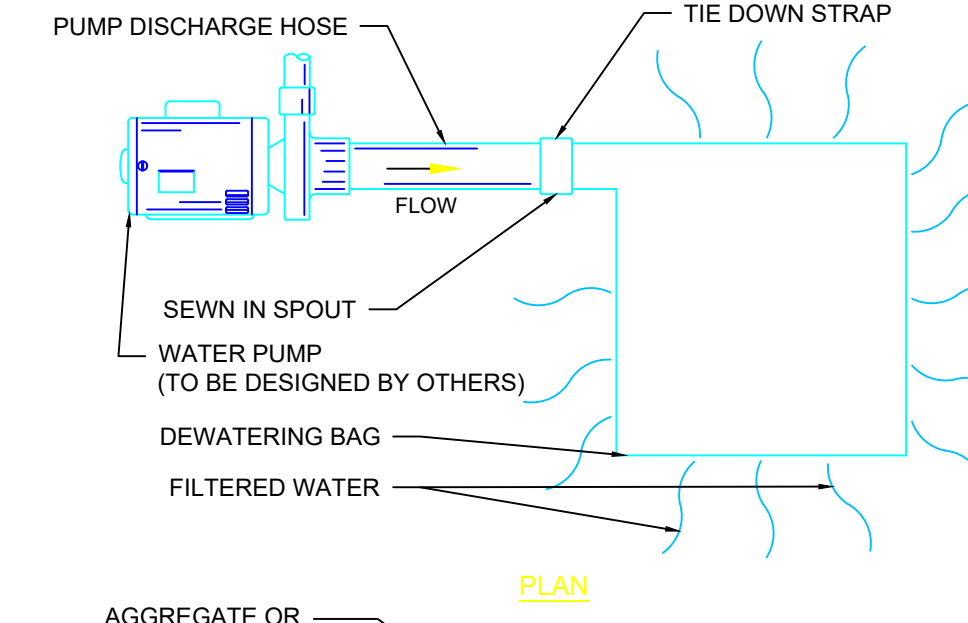

PLAN

SECTION

NOTE: THE DANDY DEWATERING BAG WILL BE MANUFACTURED IN THE U.S.A. FROM A NONWOVEN POLYPROPYLENE FABRIC THAT MEETS OR EXCEEDS THE FOLLOWING SPECIFICATIONS:

Mechanical Properties	Test Method	Units	MARV
Grab Tensile Strength	ASTM D 4532	KN (lbf)	0.9 (205) x 0.9 (205)
Grab Tensile Elongation	ASTM D 4532	%	50 x 50
Puncture Strength	ASTM D 4533	KN (lbf)	0.55 (130)
Mullen Burst Strength	ASTM D 7768	PSI (lbf/in ²)	76.18 (1380)
Triplicate Tear Strength	ASTM D 4533	KN (lbf)	0.36 (80) x 0.36 (80)
UV Resistance	ASTM D 4355	%	70
Absorpt. Opening Size	ASTM D 4951	Mm (US Std Sieve)	0.180 (80)
Flow Rate	ASTM D 4491	l/min/m ² (gpd/min/ft ²)	3866 (95)
Permeability	ASTM D 4491	Sec	1.2

E-3

DEWATERING BAG DETAIL

NOT TO SCALE

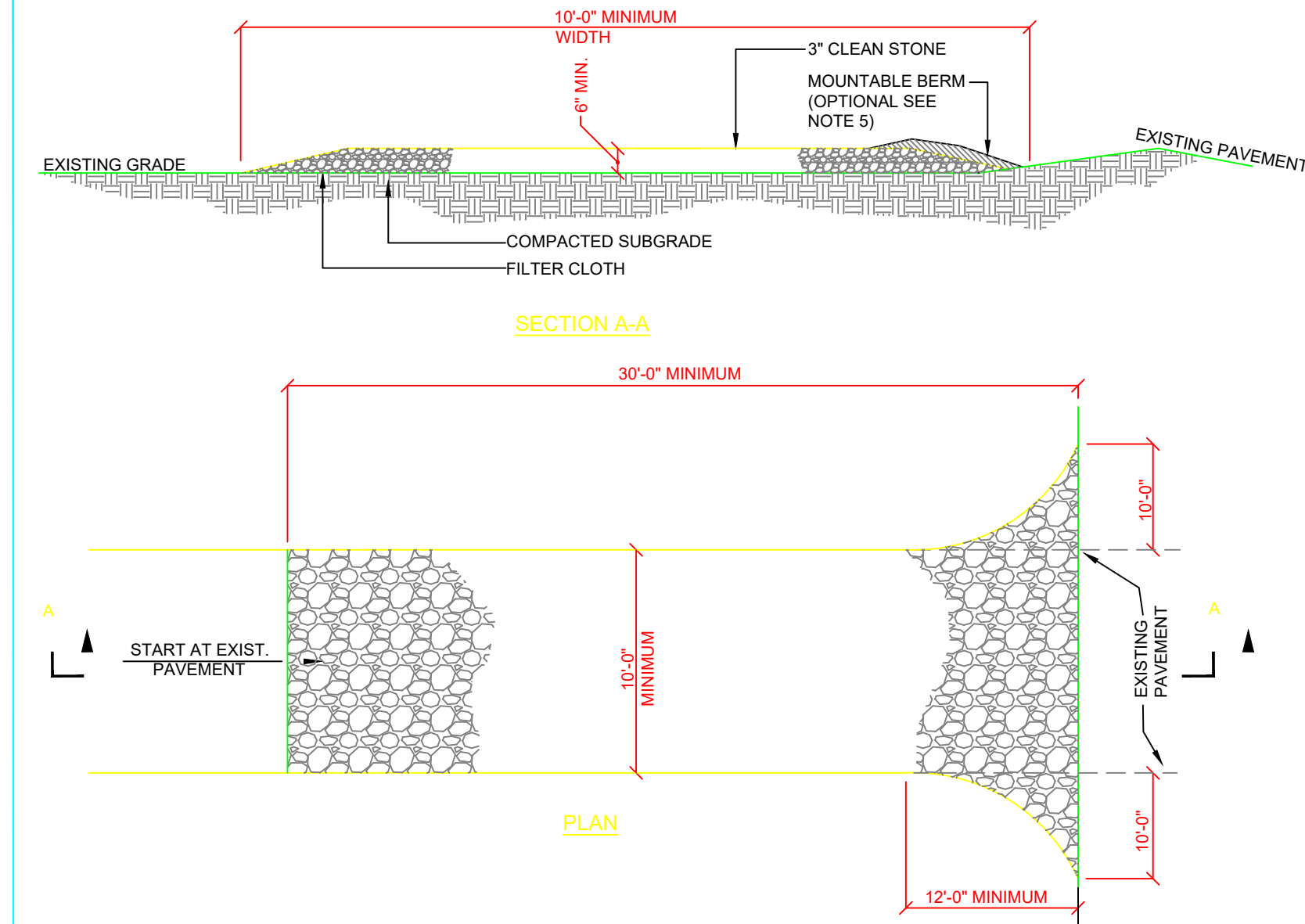

SECTION A-A

PLAN

INSTALLATION NOTES:

- Stone size - use 3" min. Stone, or reclaimed or recycled concrete equivalent.
- Length - as required, but not less than 50 feet (except on a single residence lot where a 30 foot minimum length would apply).
- Thickness - not less than six (6) inches.
- Width - 10 foot minimum, but not less than the full width at points where ingress or egress occur. 24 ft if single entrance to site.
- Surface water - all surface water flowing or diverted toward construction entrances shall be piped across the entrance. If piping is impractical, a mountable berm with 5:1 slopes will be permitted.
- Maintenance - the entrance shall be maintained in a condition which will prevent tracking or flowing of sediment onto public right of way this may require periodic top dressing with additional stone as conditions demand and repair and/or cleanouts of any measures used to trap sediment. All sediment spilled, dropped, washed or tracked onto public right of way must be removed immediately.
- Washing - wheels shall be cleaned to remove sediment prior to entrance onto public right of way. When washing is required, it shall be done on an area stabilized with stone and which drains into an approved sediment trapping device.
- Periodic inspection and needed maintenance shall be provided after each rain.

SYMBOL

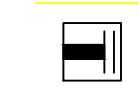

E-5

STABILIZED CONSTRUCTION ENTRANCE DETAIL

NOT TO SCALE

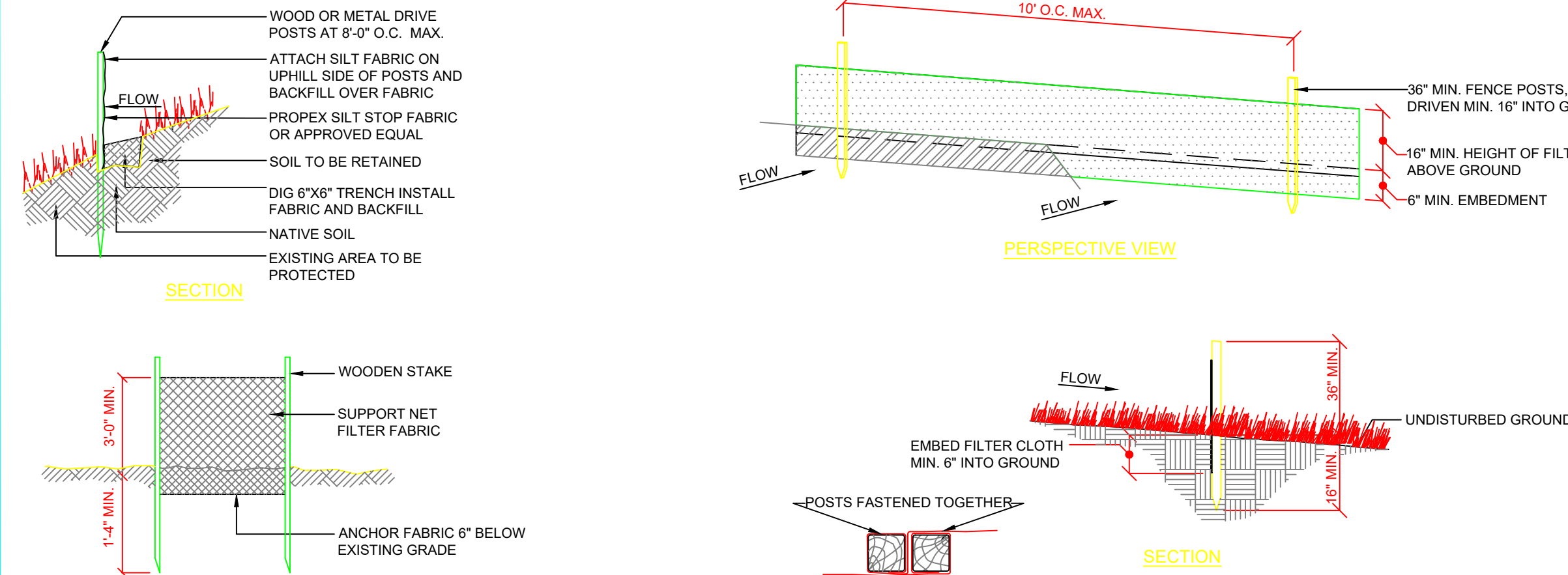

SECTION

PERSPECTIVE VIEW

SECTION

PLAN VIEW: JOINING SECTIONS

ELEVATION

SYMBOL

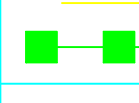

E-4

SILT FENCE DETAIL

NOT TO SCALE

NOTES:

- Filter cloth to be fastened securely to upgrade side of post: steel posts (either T or U type) or 2" hardwood posts at top and mid section.
- When two sections of filter cloth adjoin each other they shall be overlapped by 6 inches and folded. Filter cloth shall be Miraf 100x, Stabilinka T140n or approved equal.
- Maintenance shall be performed as needed and material removed when "bulges" develop in the silt fence or the capacity reaches 50%.
- Excavate 6 inch trench along the silt fence line and bury the fabric.
- Unroll a section at a time and position the post against the back (downstream) wall of the trench.
- Drive the post into the ground until the netting is approximately 2 inches from the trench bottom.
- Lay the toe-in flap of fabric onto the undisturbed bottom of the trench, backfill the trench and tamp the soil. Steeper slopes require an intercept trench.
- Join sections as shown above.

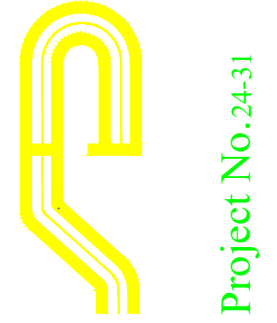

Project No. 24-31

Site Design Consultants

Civil Engineers • Land Planners
251-F Underhill Avenue, Yorktown Heights, NY 10598
(914) 962-4488 - Fax: (914) 962-7386
www.sitedesignconsultants.com

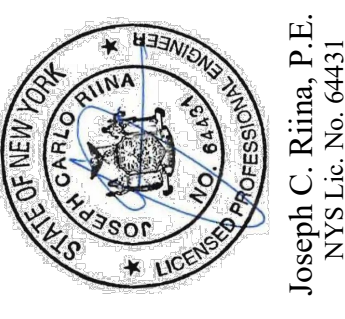

Engineer:

No.	Date	Comments
1	4/29/26	All Sewer Plan

SCALE: #####

DRAWN BY: JPT

DATE: 3-12-25

E & SC
DETAILS

TOWN OF YORKTOWN
PROJECT LOCATION
795 EAST MAIN STREET (ROUTE 6)
Westchester, NY

Sheet 6 of 7

